

# Monthly update – Parramatta

24 March 2025

Sydney Metro is Australia's biggest public transport project.

The NSW Government is delivering Sydney Metro West – a new underground metro railway which will double rail capacity between Parramatta and the Sydney CBD, link new communities to rail services and support employment growth and housing supply.

Gamuda Australia and Laing O'Rourke Consortium (GLC) has been awarded the contract to deliver nine kilometres of twin metro rail tunnels between Westmead and Sydney Olympic Park, excavation for two new metro stations, a stabling and maintenance facility at Clyde and a precast facility at Eastern Creek.

## Construction activities: April 2025

Tunnelling contractor, GLC will continue major construction at the Parramatta metro station site during April. These activities will be carried out during standard construction hours:

- **Monday to Friday 7am to 6pm and Saturday 8am to 6pm**

Work will involve:

- Archaeological investigations and backfilling of areas once complete.
- Removing concrete sections in stages with saw cutters and jackhammers.
- Piling within site near Church Street.
- Delivering and removing machinery, equipment, and materials via George Street.
- Constructing and excavating the station box including rock hammering, concreting, steel bracing installation and support work.
- Ongoing surveying, geotechnical investigations, utility investigations and upgrades within and around site.
- Aerial drone filming on-site. This will be in line with Civil Aviation Safety Authority guidelines.
- Internal cleaning of a heritage building on George Street with small plant and equipment.
- Upgrading and re-lining sewers within Macquarie Lane and United Lane.
- Installing electrical equipment and reticulation of electrical cables.

## Out-of-hours work

To minimise interruption to local traffic and to ensure the safety of motorists, pedestrians and workers around the site, some work must be undertaken outside standard construction hours.

Out-of-hours work will involve:

- Oversized machinery and equipment deliveries and removal to and from the site between **6pm and 7am from Tuesday 1 April to Wednesday 30 April 2025, excluding public holidays.**
- Survey works along Church Street, Macquarie Street and Harris Street between **2am and 4am from Tuesday 1 April to Wednesday 2 April 2025.**

We will continue to keep you informed of our progress and planned out-of-hours work. To know more, register your details to receive weekly email updates at [metro tunnelsGLC@transport.nsw.gov.au](mailto:metro tunnelsGLC@transport.nsw.gov.au).

## Update on surveying and geotechnical investigations – 197 Church Street, Parramatta

GHD are planning to continue surveying and geotechnical investigations until **Monday 14 April 2025**. Works have been extended due to complex site conditions. These activities will be carried out during standard construction hours from **Monday to Friday between 7am to 6pm and Saturday 8am to 6pm**. See map for details.

## What to expect

- Some activities will generate noise and vibration, but this will be minimised as much as possible.
- Access to businesses will be maintained unless arrangements are made with you in advance.
- Traffic control will be in place to assist motorists around the work activities on Macquarie Lane and United Lane.

## Changes to traffic, pedestrian and cyclist routes

- Temporary signage and traffic control to assist motorists, pedestrians, and cyclists with changes to traffic conditions. Allow some extra time for your journey when travelling near these areas.

**Equipment used:** Equipment for this work will include but is not limited to hand tools, cranes, generators, truck and dogs, survey equipment, light vehicles, drill rigs, excavators, rock hammer, dozers, vibratory rollers and compactors, concrete agitators, vacuum excavation trucks, tipper trucks, delivery vehicles, fencing, road saw and traffic control devices.

## Parramatta metro station work area

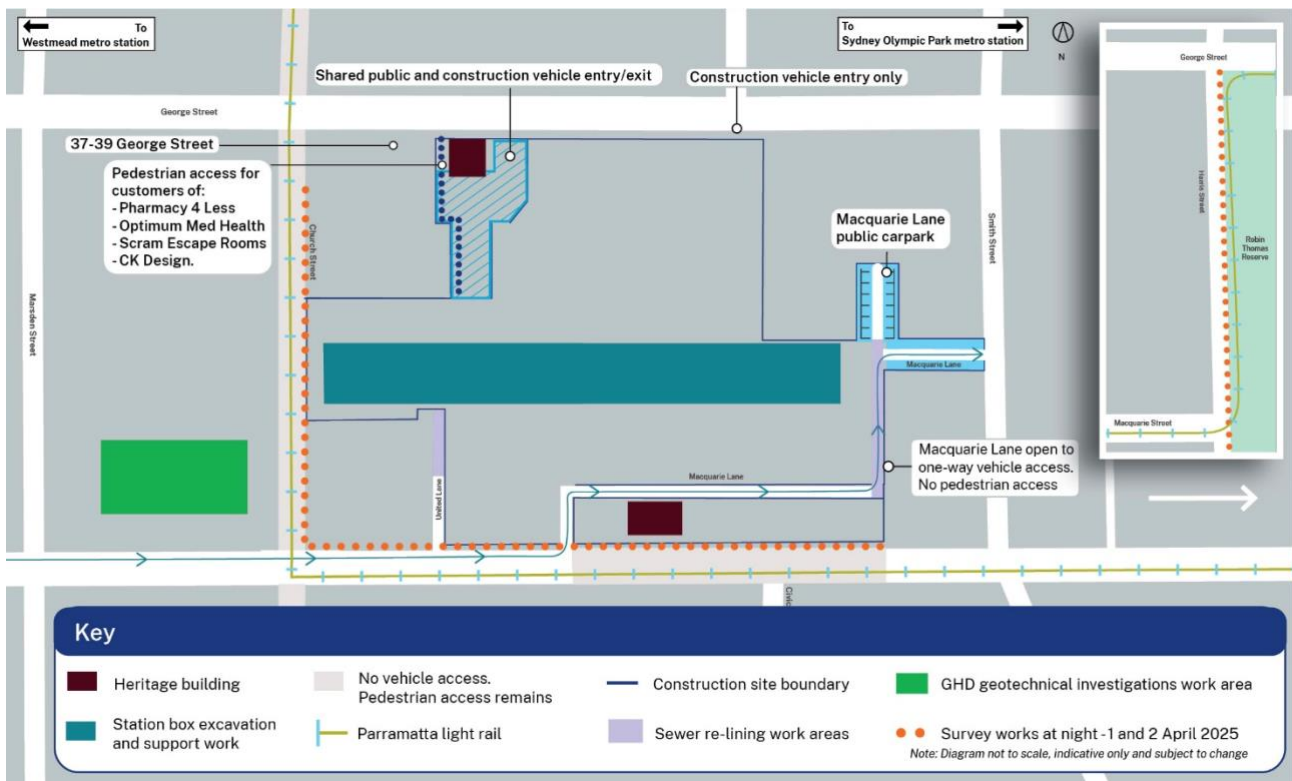

## Contact us

Please contact GLC's Community team on **1800 612 173** or by email if you have any questions, if you have any questions, complaints or would like to provide feedback about the work, including respite periods. We will continue to keep you updated on the progress of work in your area. If you would prefer to receive updates by email, please send a request to [metrotunnelsGLC@transport.nsw.gov.au](mailto:metrotunnelsGLC@transport.nsw.gov.au) and we will add you to the distribution list. Thank you for your cooperation while we complete this essential work.



**1800 612 173** Community information line open 24 hours  
[metrotunnelsGLC@transport.nsw.gov.au](mailto:metrotunnelsGLC@transport.nsw.gov.au)  
Sydney Metro West, PO Box K659, Haymarket NSW 1240



Access information in over  
100 languages

Download **Sydney Metro Connect** from  
the App Store or get it on Google Play.



If you need help understanding this information, please contact the Translating and Interpreting Service  
on **131 450** and ask them to call us on **1800 612 173**