

# Monthly update – Five Dock

March 2025

## Sydney Metro is Australia's biggest public transport project

The NSW Government is delivering Sydney Metro West – a new underground metro railway which will double rail capacity between Parramatta and the Sydney CBD, link new communities to rail services and support employment growth and housing supply.

Acciona Ferrovial Joint Venture (AFJV) has been awarded the contract to deliver 11 kilometres of twin metro rail tunnels between The Bays and Sydney Olympic Park and excavate five new metro stations including a station at Five Dock.

## Work during March

The main activities at the Five Dock Station sites throughout March will be site demobilisation at the eastern and western construction sites and ongoing cavern lining works, including delivery and removal of large mobile cranes and a series of concrete pours.

Work planned for March includes:

- Construction of shaft and cavern concrete structures
- Tunnelling support activities including central cavern construction
- Temporarily closing the top of Waterview Street at the Second Avenue intersection for one week to install a median island
- Demobilising activities at the eastern construction site including shed disassembly, temporarily closing Second Avenue while lifting equipment out of the site using a mobile crane, every Tuesday and Thursday.
- Demobilising activities at the western construction site including dismantling, and moving workforce facilities within the site, installing new hoarding and fencing within Fred Kelly Place
- Increased deliveries of equipment to and from the western and eastern construction sites using both sides of Great North Road, Waterview Street and Second Avenue
- Temporarily removing the public parking spaces from the front of the western construction site to assist with site demobilisation works, when required
- Delivering and removing materials and equipment (out-of-hours deliveries and removals will be notified separately).

### Work hours:

Unless otherwise stated, this work will be carried out during standard construction hours:

- **Monday to Friday 7am – 6pm and Saturday 8am – 6pm**

### Work outside standard construction hours:

Some work must be undertaken outside standard construction hours to minimise impacts on traffic and to ensure the safety of motorists, pedestrians, and workers.

### Out-of-hours work planned for March includes:

- Drainage works on Great North Road from **8pm and 5am on Monday 10 March 2025, Tuesday 11 March 2025, and Thursday 13 March 2025** (weather and site conditions permitting). The following Monday will be the contingency date and notified separately. (weather and site conditions permitting)
- Night work to complete the asphaltting around the median island on Waterview Street from **8pm to 5am on Friday 14 March 2025** and line marking **from 8pm to 5am on Monday 17 March 2025** (weather permitting).

- Night work to dismantle and remove large electrical equipment from the eastern construction site using a mobile crane on Second Avenue from **6pm to 5am on Tuesday 18 March 2025**. Wednesday 19 March is the contingency date and will be notified separately, if needed.
- The remaining cavern lining concrete pour hours have been extended and will now operate from **6am to 10pm**, if needed for every pour. There will be increased vehicles entering site during each pour.

Activities associated with tunnelling support, such as concrete pours, cross passage construction, defect repairs, removal of temporary infrastructure and installation of underline service crossings inside the tunnels are **approved for 24-hour operation**. This includes activities inside the eastern acoustic shed, the excavated underground cavern and the excavated shaft on the western site (under strict noise criteria). No work is planned on the surface of the western site after 6pm unless otherwise notified.

### Equipment used

Equipment used for this work includes but is not limited to: trucks, light vehicles, concrete trucks, concrete pumps, bobcat, jackhammers, elevated work platforms, excavators, street sweepers, vacuum trucks, asphaltting machines, mobile cranes, lighting towers, generators and power tools.

### Changes to traffic, pedestrian, and cyclist routes

During the work, traffic control will be in place to assist motorists, pedestrians, and cyclists with any changes to traffic conditions. This may include contraflow lanes, stop-slow traffic controls to assist with truck movements, oversized deliveries and temporary lane or footpath closures.

### Five Dock work area map

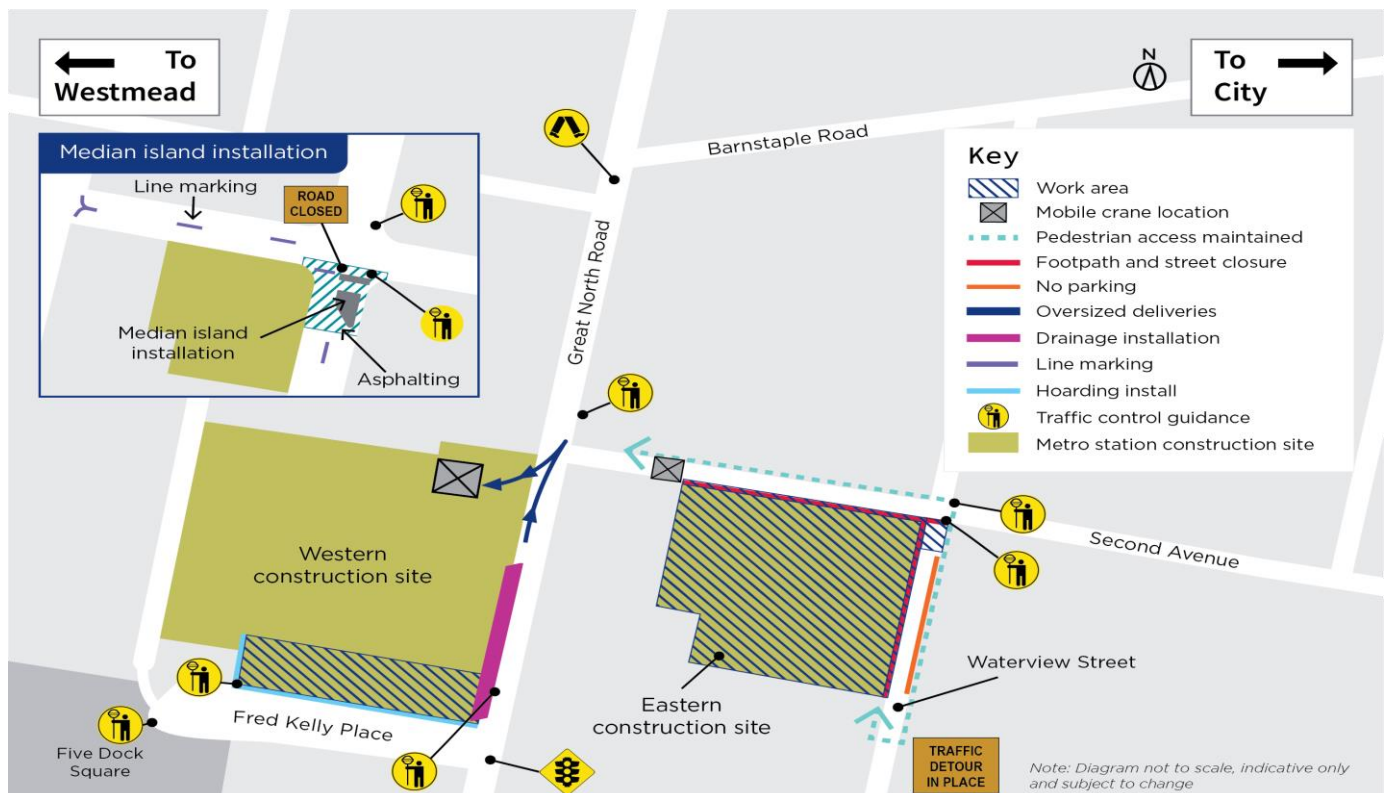

### Contact us

Please contact the AFJV community team on **1800 612 173** if you have any questions, complaints or would like to provide feedback about the work. AFJV's Community Communications Strategy is available online at [acciona.com.au/sydneymetro-west-ctp](http://acciona.com.au/sydneymetro-west-ctp) (click on plans).

**1800 612 173** Community information line open 24 hours

[metrotunnelsAFJV@transport.nsw.gov.au](mailto:metrotunnelsAFJV@transport.nsw.gov.au)

Sydney Metro West, PO Box K659, Haymarket NSW 1240



Access information in over **100 languages**

Download **Sydney Metro Connect** from the App store or get it on Google Play.



If you need help understanding this information, please contact the Translating and Interpreting Service on **131 450** and ask them to call us on **1800 612 173**