

# Monthly update – Parramatta

25 August 2023

## Sydney Metro is Australia's biggest public transport project.

The NSW Government is delivering Sydney Metro West – a new underground metro railway which will double rail capacity between Parramatta and the Sydney CBD, with a target travel time of about 20 minutes between the two centres.

Gamuda Australia and Laing O'Rourke Consortium (GLC) has been awarded the contract to deliver nine kilometres of twin metro rail tunnels between Westmead and Sydney Olympic Park, excavation for two new metro stations, a stabling and maintenance facility at Clyde and a precast facility at Eastern Creek.

## Construction activities: September 2023

Tunnelling contractor, GLC will continue major construction at the Parramatta metro station site during September. These activities will be carried out during standard construction hours:

- **Monday to Friday 7am to 6pm and Saturday 8am to 6pm.**

Work will involve:

- Ongoing archaeological investigations and backfilling of areas once complete.
- Ongoing site development including installing fencing, hoarding, barriers, and signage.
- Removing concrete sections and piles in stages with saw cutters and jackhammers.
- Constructing and commissioning a water treatment plant.
- Delivering and removing machinery, equipment, and materials via George Street.
- Constructing a diaphragm wall and support work including piling, in preparation for station box excavation.
- Surveying, utility investigations and upgrades within and around site including United Lane.
- Aerial drone filming on-site. This will be in line with Civil Aviation Safety Authority guidelines.
- Resurfacing the southern footpath with pavers in stages on Macquarie Street.

All hazardous material removal work is being undertaken in accordance with SafeWork NSW guidelines.

## Out-of-hours work

To minimise interruption to local traffic and to ensure the safety of motorists, pedestrians and workers around the site, some work must be undertaken outside standard construction hours.

Out-of-hours work will involve:

- Oversized machinery and equipment deliveries to the site between **6pm and 7am from Friday 1 September to Friday 29 September 2023.**
- Construction of diaphragm wall and support work in preparation for station box excavation **24 hours a day, Monday to Friday until February 2024.** We are continuing to plan for these activities and will keep you informed as we progress.
- Installation of water treatment plant discharge route in stages on George Street to Charles Street between **6pm and 7am, Monday to Friday** has been **extended to late October 2023** due to scheduling adjustments.

Out-of-hours activities are in line with Road Occupancy Licences; and Transport for NSW requirements to work in the road corridor and for the movement of oversized vehicles.

### What to expect

- Residents and businesses near the construction site may experience some ground-borne noise and vibration as the excavation progresses.
- Some activities will generate noise, but this will be minimised as much as possible.
- Temporary removal of parking on United Lane during utility upgrades.
- Access to businesses will be maintained unless arrangements are made with you in advance.
- Temporary signage and traffic control to assist motorists, pedestrians, and cyclists with changes to traffic conditions. Allow some extra time for your journey when travelling near these areas.

**Equipment used:** Equipment for this work will include but is not limited to hand tools, cranes, generators, truck and dogs, survey equipment, light vehicles, drill rigs, excavators, dozers, vibratory rollers and compactors, concrete agitators, vacuum excavation trucks, tipper trucks, delivery vehicles, fencing, road saw and traffic control devices.

### Parramatta work area

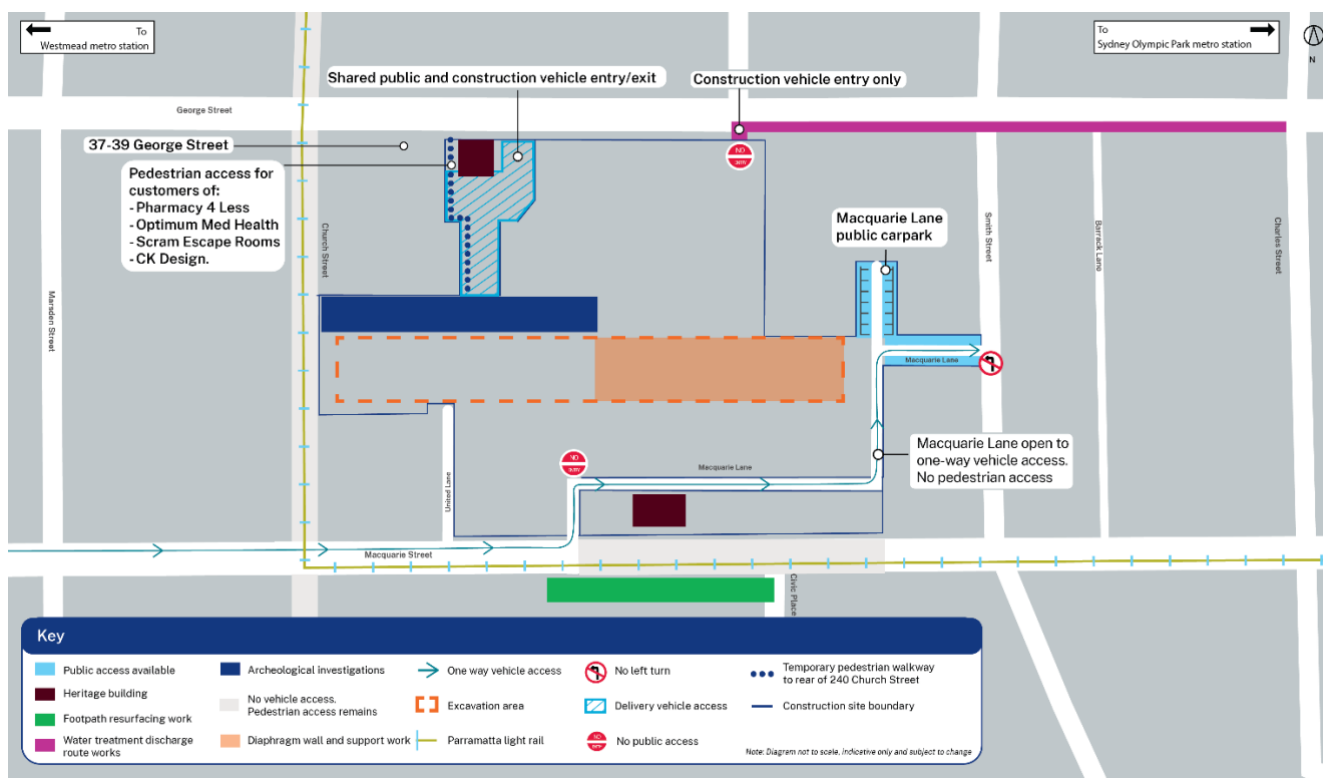

### Contact us:

Please contact Olivia from GLC’s Community team on **1800 612 173** or by email if you have any questions, complaints or would like to provide feedback about the work, including appropriate respite periods. We will continue to keep you updated on the progress of work in your area. If you would prefer to receive updates by email, please send a request to [metrotunnelsGLC@transport.nsw.gov.au](mailto:metrotunnelsGLC@transport.nsw.gov.au) and we will add you to the distribution list.

Thank you for your cooperation while we complete this essential work.

**1800 612 173** Community information line open 24 hours

[metrotunnelsGLC@transport.nsw.gov.au](mailto:metrotunnelsGLC@transport.nsw.gov.au)

Sydney Metro West, PO Box K659, Haymarket NSW 1240



Access information in over 100 languages

Download **Sydney Metro Connect** from the App store or get it on Google Play.



If you need help understanding this information, please contact the Translating and Interpreting Service on **131 450** and ask them to call us on **1800 612 173**