

Monthly update – Five Dock

March 2023

Sydney Metro is Australia's biggest public transport project.

The NSW Government is delivering Sydney Metro West – a new underground metro railway which will double rail capacity between Parramatta and the Sydney CBD, with a target travel time of about 20 minutes between the two centres.

Sydney Metro has been granted planning approval to construct twin underground rail tunnels between Westmead and Hunter Street in the Sydney CBD for Sydney Metro West. Acciona Ferrovia Joint Venture (AFJV) has been awarded the contract to deliver 11 kilometres of twin metro rail tunnels between The Bays and Sydney Olympic Park and excavate five new metro stations including a station at Five Dock.

Site establishment and excavation work

Site establishment and excavation work will continue at the Five Dock Station sites throughout March. The main activities will include concreting work, shaft excavation, installation of site utilities and equipment.

Work planned for March includes:

Eastern site

- Continuing shaft excavation
- Installation and commissioning of water treatment plant equipment
- Installation of electrical switchyard equipment and site services
- Road repairs in Second Avenue next to the eastern site
- Concreting work including shaft and retaining walls
- Adjustment of fencing and hoarding along the site boundaries as work progresses
- Delivery and removal of materials and equipment (any out-of-hours deliveries will be notified separately)

Western site

- Earthworks and shaft excavation
- Concreting work including for capping beams, pavements, shaft and retaining walls
- Installation of ground anchors
- Installation of truck bridge, gantry crane and electrical equipment
- Flushing water through new pipes on Great North Road for disinfection
- Adjustment of fencing and hoarding along the site boundaries as work progresses
- Delivery and removal of materials and equipment (any out-of-hours deliveries will be notified separately)

Work hours

Unless otherwise stated above, this work will be carried out during standard construction hours:

- **Monday to Friday 7am – 6pm and Saturday 8am – 6pm**

Some work must be undertaken outside standard construction hours to minimise impacts on traffic and to ensure the safety of motorists, pedestrians and workers. Separate notifications will continue to be provided for this work.

With the acoustic shed on the eastern site now complete, **the approved hours of work inside the shed have extended to 24 hours per day under strict noise criteria.**

Tunnelling, cross passages and cavern excavation are approved for 24-hour operation however **truck haulage of excavated material from the site will not occur between 10pm and 7am.**

Equipment used

Equipment used for this work includes but is not limited to: trucks, light vehicles, excavators with hammer attachment, watercarts, concrete saws, drill rigs, jack hammers, vacuum trucks, bulldozers, concrete trucks, hand tools, road profiler, rollers, plate compactors, street sweepers, cranes and generators.

Changes to traffic, pedestrian and cyclist routes

During the work, traffic control will be in place to assist motorists, pedestrians and cyclists with any changes to traffic conditions. This may include contraflow lanes, stop-slow traffic controls and temporary lane or footpath closures. The watermain work on Great North Road will require temporary footpath closures with a pedestrian detour in place during the work.

Five Dock work area map

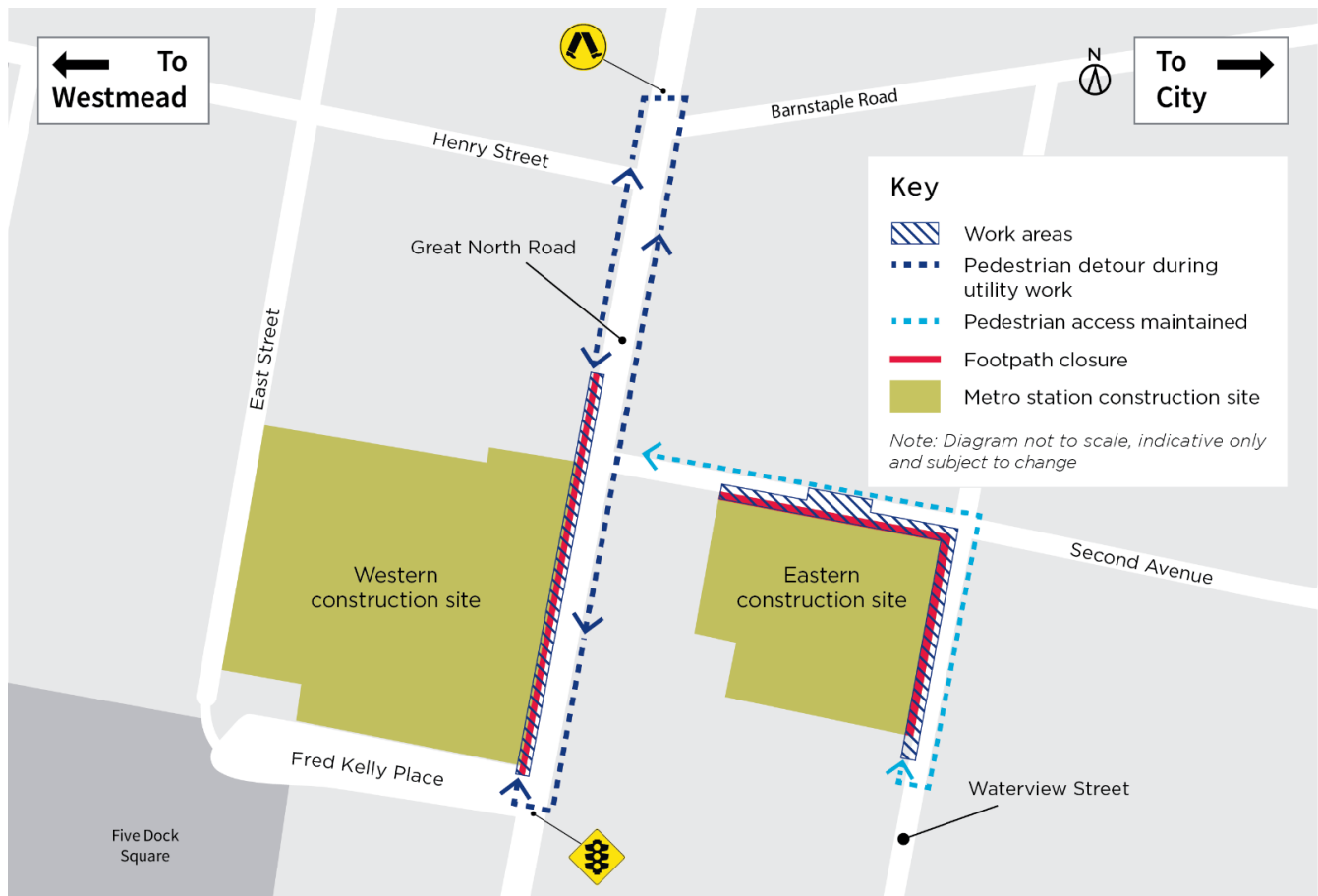

Contact us

Please contact Jeremy from the AFJV community team on **1800 612 173** if you have any questions, complaints or would like to provide feedback about the work. AFJV's Community Communications Strategy is available online at acciona.com.au/sydney-metro-west-ctp (plans). If you would like to provide feedback on this plan, please contact the AFJV community team.

We will continue to keep you updated on the progress of work in your area. If you would prefer to receive updates by email, please send a request to metrotunnelsAFJV@transport.nsw.gov.au and we will add you to the distribution list.

Sydney Metro has launched Sydney Metro Connect – a new way to stay informed. You can download Sydney Metro Connect on the App Store or get it on Google Play. Thank you for your understanding during this essential work.

 **1800 612 173** Community information line open 24 hours

 MetrotunnelsAFJV@transport.nsw.gov.au

 Sydney Metro West, PO Box K659, Haymarket NSW 1240

 If you need an interpreter, contact TIS National on **131 450** and ask them to call **1800 612 173**



Sydney Metro Connect
Use the QR code to download from
the App Store or Google Play.

