

Notification – Central Station

6 March 2023

Sydney Metro is Australia's biggest public transport project.

Services started in May 2019 in the city's North West with a train every four minutes in the peak. Metro rail will be extended into the CBD and beyond to Bankstown in 2024 with new CBD metro railway stations at Martin Place, Pitt Street and Barangaroo and new metro platforms at Central. By 2030, Sydney will have four metro lines, with 46 stations and 113 kilometres of new metro rail.

Laing O'Rourke is delivering the new Sydney Metro platforms under Central Station as well as the landmark Central Walk - a new underground pedestrian concourse to help customers get around Sydney's busiest railway station.

Work at 20-28 Chalmers Street – Temporary partial road closure of Randle Lane, Surry Hills

New service connection and installation work is continuing within our site at 20-28 Chalmers Street. As part of the ongoing construction works, Randle Lane must undergo final reinstatement of the road pavement for which a temporary partial lane closure is required during excavation and roadworks. Two-way traffic will be in place in Randle Lane from **7am, Monday 13 March 2023**, for approximately two months ([see map overleaf](#)).

On **Tuesday 14 March 2023**, vehicle access will be limited on Randle Lane for a test lift involving a mobile crane. This test lift will take approximately two hours and will be scheduled outside of peak travel times between 10am and 2pm. Our project team will work with businesses and residents to provide access where required during this time, however you may experience a short delay. Traffic control will be in place to safely direct motorists.

What to expect

- Removal of scaffolding from Randle Lane.
- Excavation involving asphalt hammering will be required. High-impact noise and vibration activities are only permitted from 8am until 6pm Monday to Friday, and from 8am until 1pm on Saturdays. A one-hour respite period will be provided following three hours of noise-intensive work.
- Equipment and plant to be used during this work will include an excavator, vacuum truck, jack hammer, concrete saw, hand tools and light vehicles.

Access to Randle Lane

- Randle Lane will operate two-way, with traffic control in place at each end of Randle Lane. It will remain open for local traffic only, enabling residents and businesses to access private carparks.
 - Access and egress will be available from the north via Elizabeth Street, or from the south via Randle Street.
 - Residents and businesses are advised to follow directions from traffic controllers to gain access.
- Access to private properties and emergency exits onto Randle Lane will be maintained. Impacted stakeholders will be contacted in due time.
- Waste collection will operate as usual.
- Other road users, cyclists and pedestrians should avoid Randle Lane and follow the directions of traffic controllers at all times.

Work area behind 20-28 Chalmers Street, in Randle Lane

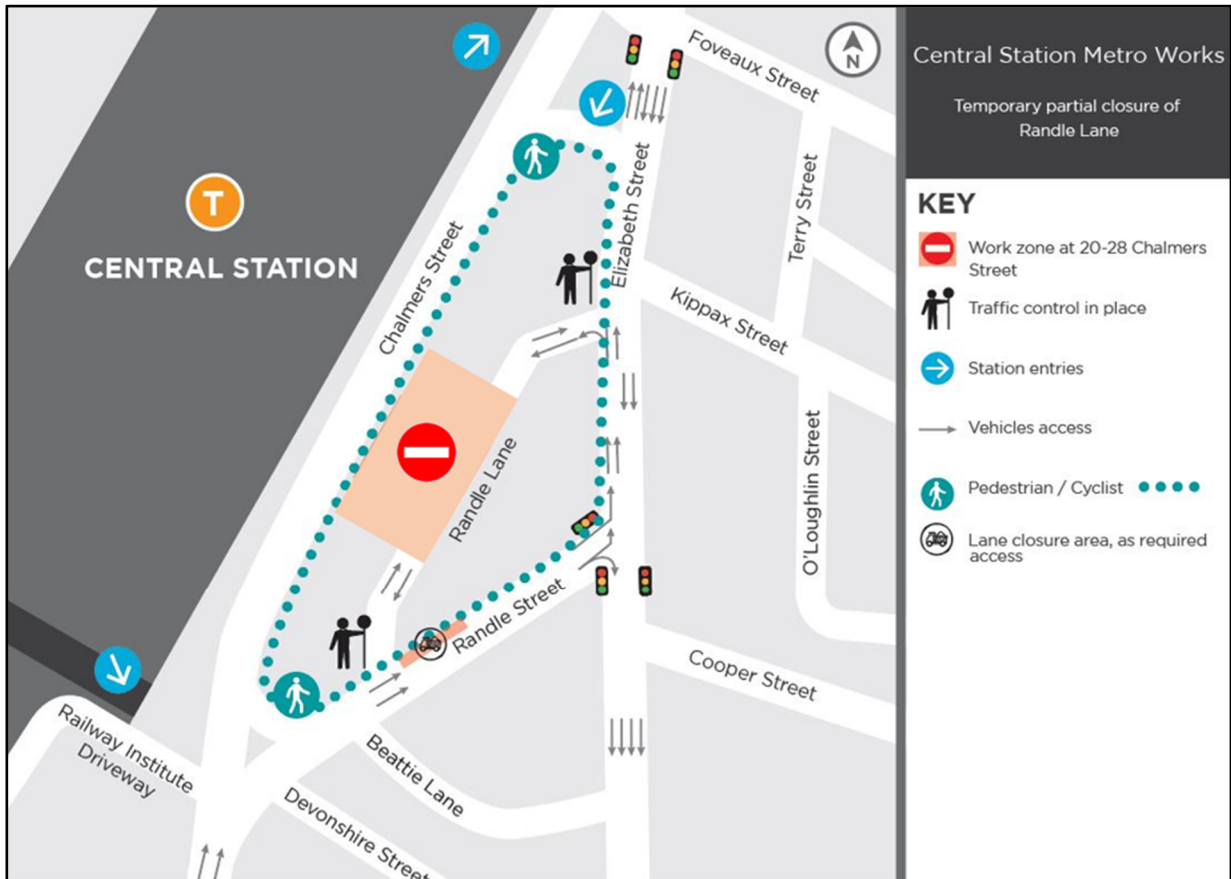

Thank you for your patience while we undertake these necessary works. Please register for email updates at sydneymetro.info for further information, or contact us on **1800 171 386** or via centralstationmetro@transport.nsw.gov.au.

SMCSWCSM-LOR-SMC-CL-COM-000155

- 1800 171 386** Community information line open 24 hours
- sydneymetro@transport.nsw.gov.au**
- Sydney Metro City & Southwest, PO Box K659, Haymarket NSW 1240
- If you need an interpreter, contact TIS National on **131 450** and ask them to call **1800 171 386**