

## Notification – Five Dock

13 February 2023

Sydney Metro is Australia's biggest public transport project.

The NSW Government is delivering Sydney Metro West - a new underground metro railway which will double rail capacity between Parramatta and the Sydney CBD, with a target travel time of about 20 minutes between the two centres. Sydney Metro was granted planning approval to construct twin underground rail tunnels between Westmead and The Bays for Sydney Metro West in March 2021. Acciona Ferrovial Joint Venture (AFJV) has been awarded the contract to deliver 11 kilometres of twin metro rail tunnels between The Bays and Sydney Olympic Park and excavate five new metro stations, including a station at Five Dock.

### Revised out-of-hours work shifts at Five Dock

The tunnelling contractor, AFJV is working with Sydney Water to install new water supply lines in Great North Road Five Dock. Part of this work must occur outside standard construction hours to minimise impacts on traffic, water supply and to ensure the safety of motorists, pedestrians and workers.

This work was previously notified to occur **between 7pm and 5am** on **Monday 13, Tuesday 14 and Thursday 16 February 2023** but will continue on **Monday, Tuesday and Thursday** nights until **Monday 13 March 2023**.

AFJV is also working with Ausgrid to connect the new high voltage electricity supply to the construction sites in Great North Road and Second Avenue Five Dock. This work will occur on **Monday 20 February 2023 between 9pm and 5am**.

Delivery of an excavator to the eastern construction site will still occur on **Tuesday 14 February 2023 between 9pm and 4am** (contingency date is Thursday 16 February 2023). Due to road restrictions for oversized equipment, the delivery needs to be undertaken at night to minimise interruption to traffic and to ensure the safety of motorists, pedestrians, cyclists and workers. Delivery will only take around an hour to complete.

#### The work will include:

- Saw cutting and hammering to open trenches in concrete or asphalt on the footpath
- Removing material with a vacuum suction truck to expose existing underground utilities
- Installing a new watermain and connections including some concreting
- Flushing the watermain with a vacuum truck
- Connecting underground cables to the high voltage supply network and power pole
- Backfilling and covering trenches with steel plates at the end of each nightshift for daytime pedestrian use
- Parking the oversize semi-trailer in the south bound lane on Great North Road (see map overleaf)
- Unloading the excavator from the semi-trailer and driving it into the eastern construction site only

#### What to expect:

- There will be noise associated with this work, but we will try to minimise this as much as possible
- Noisy work such as saw cutting or hammering will be finished before midnight
- Noise blankets will be in place where practical to reduce noise from this work
- Access to properties will be maintained at all times
- The supply connection on **Monday 13 March** will include an overnight **water supply outage for up to seven hours. Sydney Water will notify impacted customers directly**. If you are not contacted by Sydney Water you will not be affected.
- The high voltage connection work on **Monday 20 February** may include an overnight power supply interruption for some properties. Ausgrid will advise affected residents directly seven (7) days before the outage. If you are not contacted by Ausgrid you will not be affected.

## Equipment used:

Equipment used for this work includes but is not limited to: oversize semi-trailer, excavators and hammer attachment, vacuum truck, concrete saw, generator, concrete truck, light vehicles, tipper trucks, plate compactor, drum roller, street sweeper, elevated work platform, lighting towers, tool van, traffic signage and hand tools.

## Changes to traffic, pedestrian and cyclist routes:

Traffic control will be in place to assist motorists, pedestrians and cyclists with temporary changes to traffic conditions including potential stop-go traffic controls, pedestrian detours and partial road closures during the work. There will be temporary footpath closures and pedestrian detours in place on Great North Road during this out-of-hours work. Pedestrian access will always be maintained on one side of Great North Road during this work.

## Five Dock out-of-hours work locations

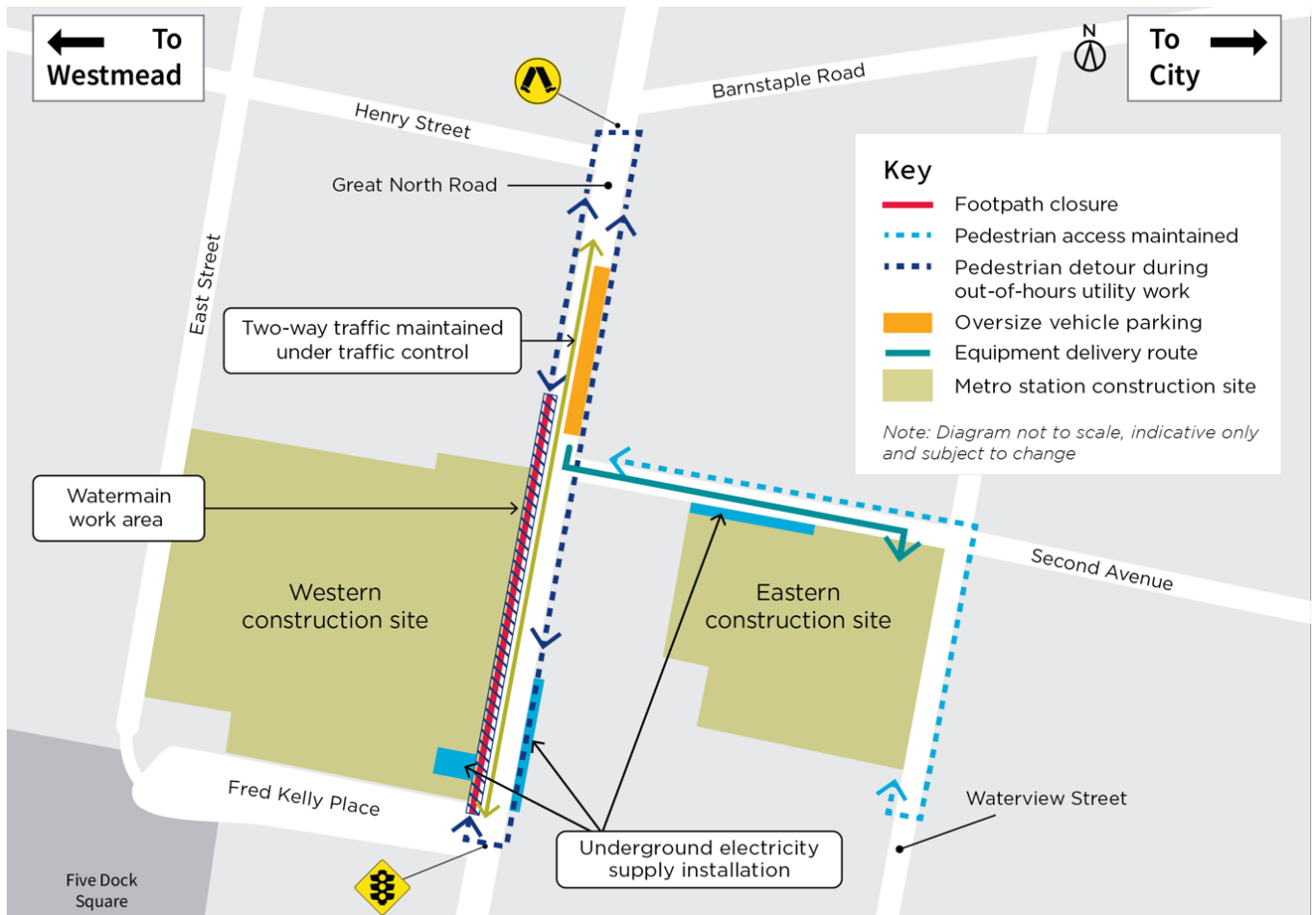

## Contact us:

Please contact Jeremy from the AFJV community team on 1800 612 173 if you have any questions or would like to provide feedback about the work, including appropriate respite periods. We will continue to keep you updated on the progress of work in your area. If you would prefer to receive updates by email, please send a request to [metrotunnelsAFJV@transport.nsw.gov.au](mailto:metrotunnelsAFJV@transport.nsw.gov.au) and we will add you to the distribution list. Sydney Metro has launched Sydney Metro Connect - a new way to stay informed.

You can download Sydney Metro Connect on the App Store or get it on Google Play.

-  **1800 612 173** Community information line open 24 hours
-  [MetrotunnelsAFJV@transport.nsw.gov.au](mailto:MetrotunnelsAFJV@transport.nsw.gov.au)
-  Sydney Metro West, PO Box K659, Haymarket NSW 1240
-  If you need an interpreter, contact TIS National on **131 450** and ask them to call **1800 612 173**



Sydney Metro Connect  
Use the QR code to download from the App Store or Google Play.

