

Monthly update – North Strathfield

3 January 2023

Sydney Metro is Australia's biggest public transport project.

The NSW Government is delivering Sydney Metro West – a new underground metro railway which will double rail capacity between Parramatta and the Sydney CBD, with a target travel time of about 20 minutes between the two centres.

Sydney Metro has been granted planning approval to construct twin underground rail tunnels between Westmead and Hunter Street in the Sydney CBD for Sydney Metro West. Acciona Ferrovial Joint Venture (AFJV) has been awarded the contract to deliver 11 kilometres of twin metro rail tunnels between The Bays and Sydney Olympic Park and excavate five new metro stations, including a station at North Strathfield.

Transport for Tomorrow (T4T) has been awarded the contract to relocate the current overhead high voltage cables to a new underground route within the rail corridor and along Queen Street.

Site preparation and establishment work

The tunnelling contractor, AFJV will continue site preparation and establishment work within and around the North Strathfield metro station site during January to prepare for the start of major construction. Unless otherwise stated below, these activities will be carried out during standard construction hours:

- Monday to Friday 7am – 6pm and Saturday 8am – 6pm

AFJV work in January includes:

- Construction of the piling platform
- Piling for the permanent retaining wall
- Concrete slab construction, traffic barrier and hoarding installation around the site
- Compound establishment work (power connection, awning installation)
- Installation of underground services for onsite utility connections
- Utility investigation and relocation work along Queen, Waratah and Wellbank streets
- Traffic signal modification work at the intersections of Concord Road and Wellbank Street as well as George and Pomeroy streets
- Delivery and removal of oversize equipment
- Ausgrid has scheduled **electrical outages between 7am and 6pm on Tuesday 10 January 2023 and will directly notify customers affected by the outage** closer to the date

Work outside standard construction hours

Some of the utility and concrete barrier installation work as well as oversize equipment deliveries must be undertaken outside standard construction hours and will be carried out between **8pm and 5am on Monday, Wednesday and Thursday** nights from **Tuesday 10 January to Friday 3 February 2023**. At times, low impact concreting work within the construction site may extend beyond standard construction hours between 6pm and 10pm during weekdays.

Changes to traffic, pedestrian and cyclist routes

This work will involve partial road and footpath closures on Queen Street as well as short-term, staged parking removal while work occurs. Two-way traffic will be maintained around the work sites on Queen Street but there may be minor traffic delays. Property and driveway access will be maintained.

Delivery of the majority of oversize equipment will come from Wellbank Street to enter site. At times, larger machinery will be required to enter or exit Queen Street via Waratah Street as a result of the tight turning conditions and overhead powerlines on Queen and Wellbank streets. At times, over height plant will be delivered or removed

from site by being unloaded or loaded from floats on Waratah Street, just east of the Tenterfield Street intersection, and tracked to and from the site.

T4T work in January

Transport for Tomorrow (T4T) is undertaking enabling work within and around the North Strathfield metro station site to prepare for the construction of Sydney Metro. T4T work in January will involve general site clean-up, cabling work, and work on aerial feeders and poles. All work will be completed within our construction sites during standard construction hours (**7am to 6pm Monday to Friday, 8am to 6pm on Saturdays**).

Equipment used:

Equipment will include: trucks, light vehicles, excavators, graders, rattle guns, watercarts, concrete saws, bobcats, jack hammers, vacuum trucks, vibratory rollers, cranes, piling rigs, elevated work platforms, concrete trucks/pumps, street sweeper and hand tools.

North Strathfield metro station work area

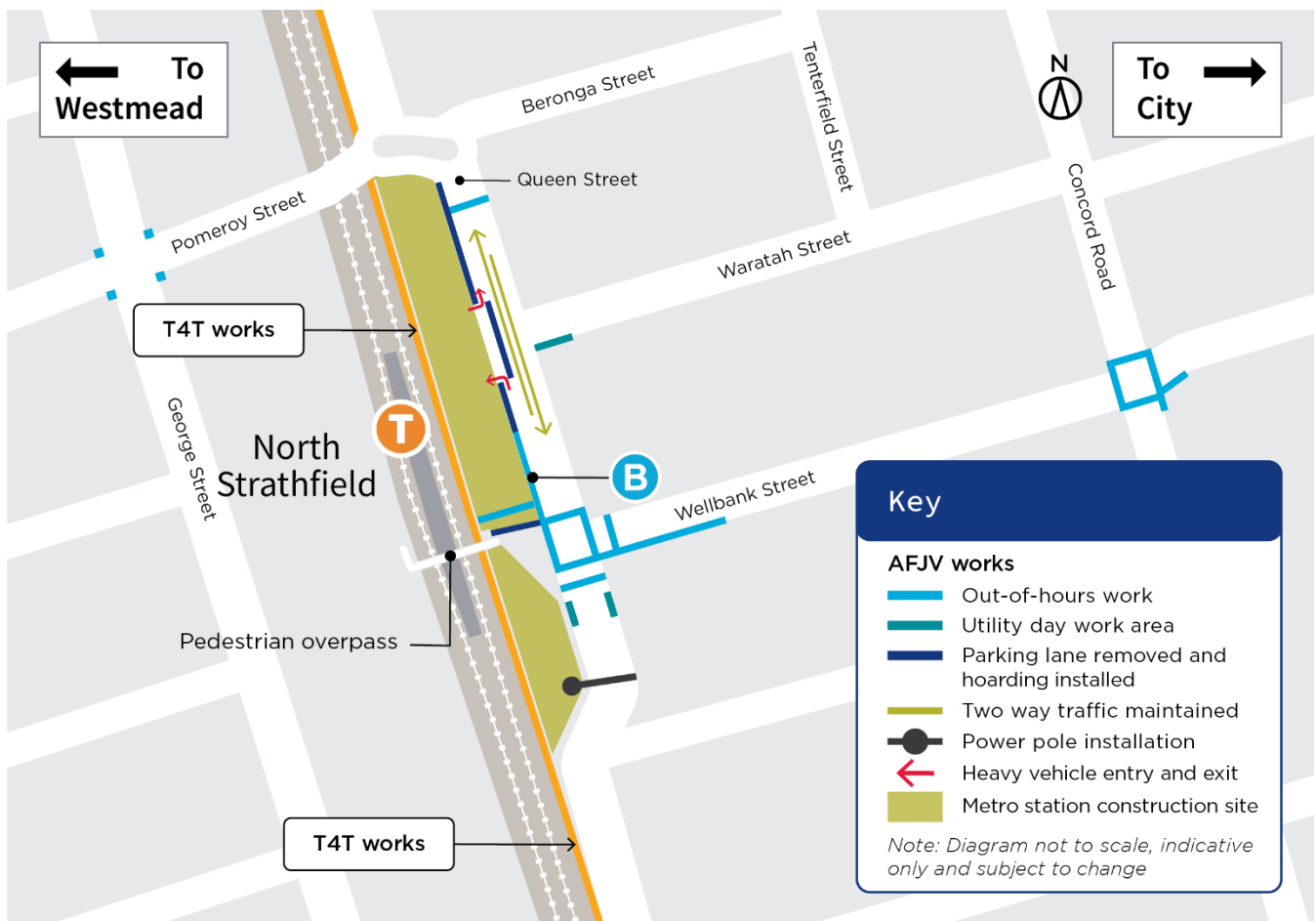

Contact us:

Please contact Liz from the AFJV community team on 1800 612 173 or by email if you have any questions, complaints or would like to provide feedback about the work, including appropriate respite periods. We will continue to keep you updated on the progress of work in your area. If you would prefer to receive updates by email, please send a request to metrotunnelsAFJV@transport.nsw.gov.au and we will add you to the distribution list. Thank you for your cooperation while we complete this essential work.

📞 **1800 612 173** Community information line open 24 hours

✉️ **MetrotunnelsAFJV@transport.nsw.gov.au**

📄 Sydney Metro West, PO Box K659, Haymarket NSW 1240

🗣️ If you need an interpreter, contact TIS National on **131 450** and ask them to call **1800 612 173**



Sydney Metro Connect
Use the QR code to download from
the App Store or Google Play.

