

Monthly update – Five Dock

February 2023

Sydney Metro is Australia's biggest public transport project.

The NSW Government is delivering Sydney Metro West – a new underground metro railway which will double rail capacity between Parramatta and the Sydney CBD, with a target travel time of about 20 minutes between the two centres.

Sydney Metro has been granted planning approval to construct twin underground rail tunnels between Westmead and Hunter Street in the Sydney CBD for Sydney Metro West. Acciona Ferrovial Joint Venture (AFJV) has been awarded the contract to deliver 11 kilometres of twin metro rail tunnels between The Bays and Sydney Olympic Park and excavate five new metro stations including a station at Five Dock.

Site preparation and establishment work

Site preparation and establishment work within and around the Five Dock Station sites will continue throughout February. The main activities will include acoustic shed construction, concreting work, installation of utilities and shaft excavation.

Work planned for February includes:

Eastern site

- Continuing construction of the acoustic shed
- Continuing shaft excavation
- Mechanical and electrical fit out of gantry crane
- Installation and commissioning of water treatment plant equipment
- Installation of electrical switchyard and site services
- Trenching across Waterview Street for utility installation and pavement repairs on Second Avenue
- Delivery and removal of materials and equipment (any out-of-hours deliveries will be notified separately)
- Adjustment of fencing and hoarding along the site boundaries as work progresses

Western site

- Earthworks
- Concreting work including for capping beams, slabs, pavements and retaining walls
- Installation of acoustic shed frame and walls
- Installation of ground anchors
- Installation of electrical switchyard and site services
- Installation of gantry crane columns
- Removal of temporary fencing next to the site boundary at Fred Kelly Place
- Replacement of water supply pipes in East Street and Great North Road
- Adjustment of fencing and hoarding along the site boundaries as work progresses
- Delivery and removal of materials and equipment (any out-of-hours deliveries will be notified separately)

Work hours

Unless otherwise stated above, this work will be carried out during standard construction hours:

- **Monday to Friday 7am – 6pm and Saturday 8am – 6pm**

Some work must be undertaken outside standard construction hours to minimise impacts on traffic and to ensure the safety of motorists, pedestrians and workers. Separate notifications will continue to be provided for this work.

Construction hours inside the acoustic shed

Once the acoustic shed on the eastern site is completed, **the approved hours of work will extend to 10pm.** Tunnelling, cross passages and cavern excavation is approved for 24 hour operation however truck haulage from the site will not occur after 10pm.

Equipment used

Equipment used for this work includes but is not limited to: trucks, light vehicles, excavators, watercarts, concrete saws, drill rigs, jack hammers, vacuum trucks, concrete trucks, hand tools, rollers, plate compactors, street sweepers, cranes and generators.

Changes to traffic, pedestrian and cyclist routes

During the work, traffic control will be in place to assist motorists, pedestrians and cyclists with any changes to traffic conditions. This may include contraflow lanes, stop-slow traffic controls and temporary lane or footpath closures. East Street will be "Local Access Only" under traffic control guidance during work to upgrade the water supply pipes. Utility work on Great North Road will require footpath closures with a pedestrian detour in place temporarily.

Five Dock work area map

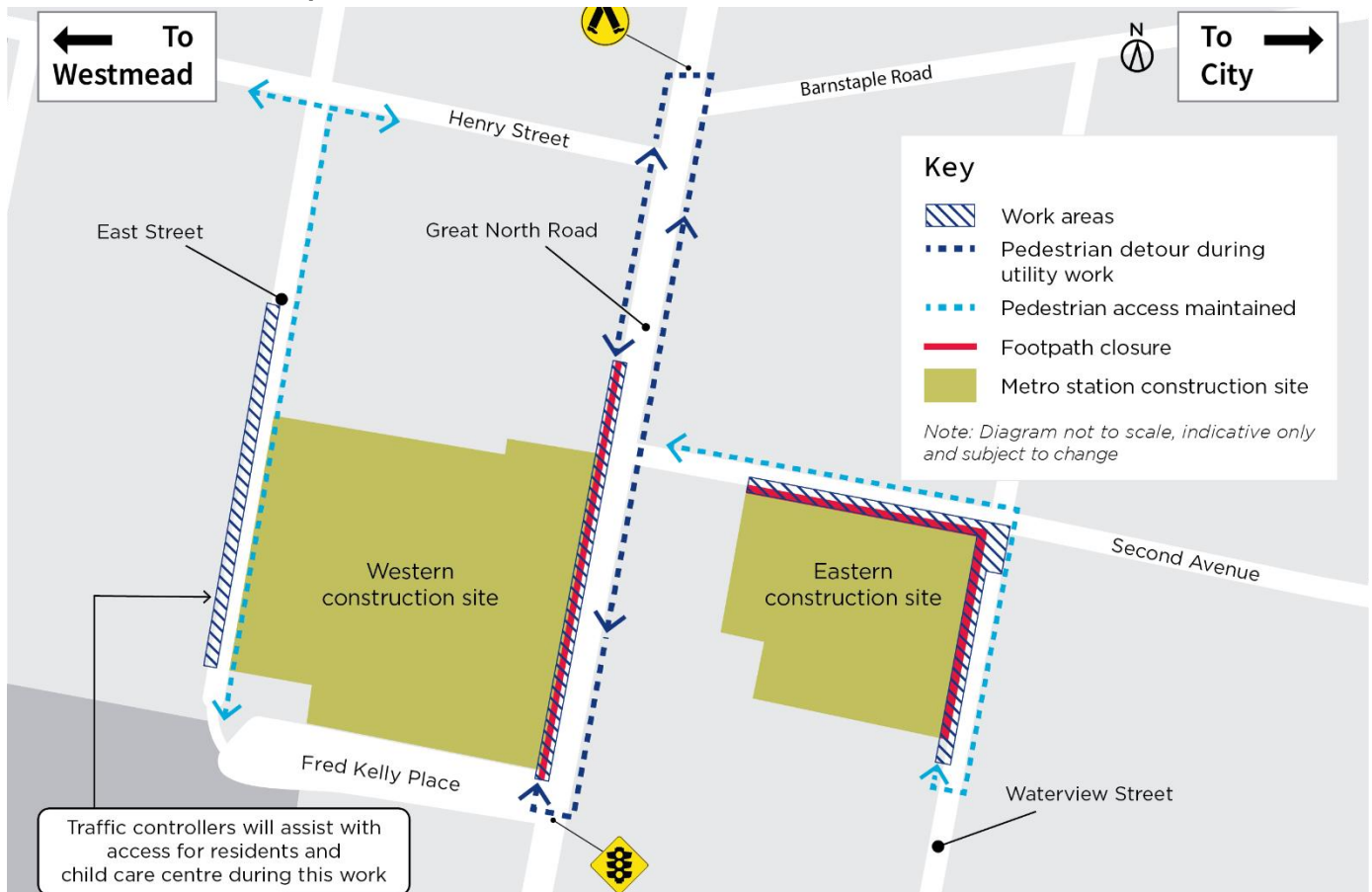

Contact us

Please contact Jeremy from the AFJV community team on **1800 612 173** if you have any questions, complaints or would like to provide feedback about the work. AFJV's Community Communications Strategy is available online at acciona.com.au/sydney-metro-west-ctp (plans). If you would like to provide feedback on this plan please contact the AFJV community team.

We will continue to keep you updated on the progress of work in your area. If you would prefer to receive updates by email, please send a request to metrotunnelsAFJV@transport.nsw.gov.au and we will add you to the distribution list.

Sydney Metro has launched Sydney Metro Connect – a new way to stay informed. You can download Sydney Metro Connect on the App Store or get it on Google Play. Thank you for your understanding during this essential work.

- 1800 612 173** Community information line open 24 hours
- MetrotunnelsAFJV@transport.nsw.gov.au
- Sydney Metro West, PO Box K659, Haymarket NSW 1240
- If you need an interpreter, contact TIS National on **131 450** and ask them to call **1800 612 173**



Sydney Metro Connect
Use the QR code to download from the App Store or Google Play.

