

Notification – Central Station

11 January 2023

Sydney Metro is Australia's biggest public transport project.

Services started in May 2019 in the city's North West with a train every four minutes in the peak. Metro rail will be extended into the CBD and beyond to Bankstown in 2024 with new CBD metro railway stations at Martin Place, Pitt Street and Barangaroo and new metro platforms at Central. By 2030, Sydney will have four metro lines, with 46 stations and 113 kilometres of new metro rail.

Laing O'Rourke is delivering the new Sydney Metro platforms under Central Station as well as the landmark Central Walk - a new underground pedestrian concourse to help customers get around Sydney's busiest railway station.

Work at 20-28 Chalmers Street – Temporary partial road closure of Randle Lane, Surry Hills

The construction of the new entrance to Central Station at 20-28 Chalmers Street is continuing. As part of the ongoing construction works the removal of the recovery crane via a mobile crane is required to be undertaken. This will require a temporary partial closure of Randle Lane at the following times **Thursday 19 to Saturday 21 January 2023** (5am – 6pm) and is weather dependant. ([see map overleaf](#))

What to expect

- Works scheduled between 5am and 7am are preparation work only – construction activities will start from 7am weekdays and 8am Saturday.
- Should the above dates not be possible, Sydney Metro is planning the work on **contingency dates** in the following week – two consecutive working days between **Monday 23 January** and **Friday 27 January** (5am – 6pm).
- High-impact noise and vibration activities will only occur when permitted Monday to Friday (8am-6pm) and Saturday (8am-1pm).
- Machinery used during this work include: mobile crane, construction vehicles and hand tools. Some construction vehicle movements should be expected in and around Randle Lane.

Access to Randle Lane

- Randle Lane will operate two-way, with traffic control in place at each end of Randle Lane. It will remain open for local traffic only, enabling residents and businesses to access private carparks.
 - Access and egress will be available from the north via Elizabeth Street, or from the south via Randle Street.
 - Residents and businesses are advised to follow directions from traffic controllers to gain access.
- Access to private properties and emergency exits onto Randle Lane will be maintained at all times.
- Waste collection will operate as usual.
- During the crane removal and subsequent liftings, delays may be experienced at times; the team will make every effort to facilitate access in a timely manner. Please follow signage and directions of traffic control in the area
- Other road users, cyclists and pedestrians should avoid Randle Lane and always follow the directions of traffic control.

Work area at 20-28 Chalmers Street, in Randle Lane

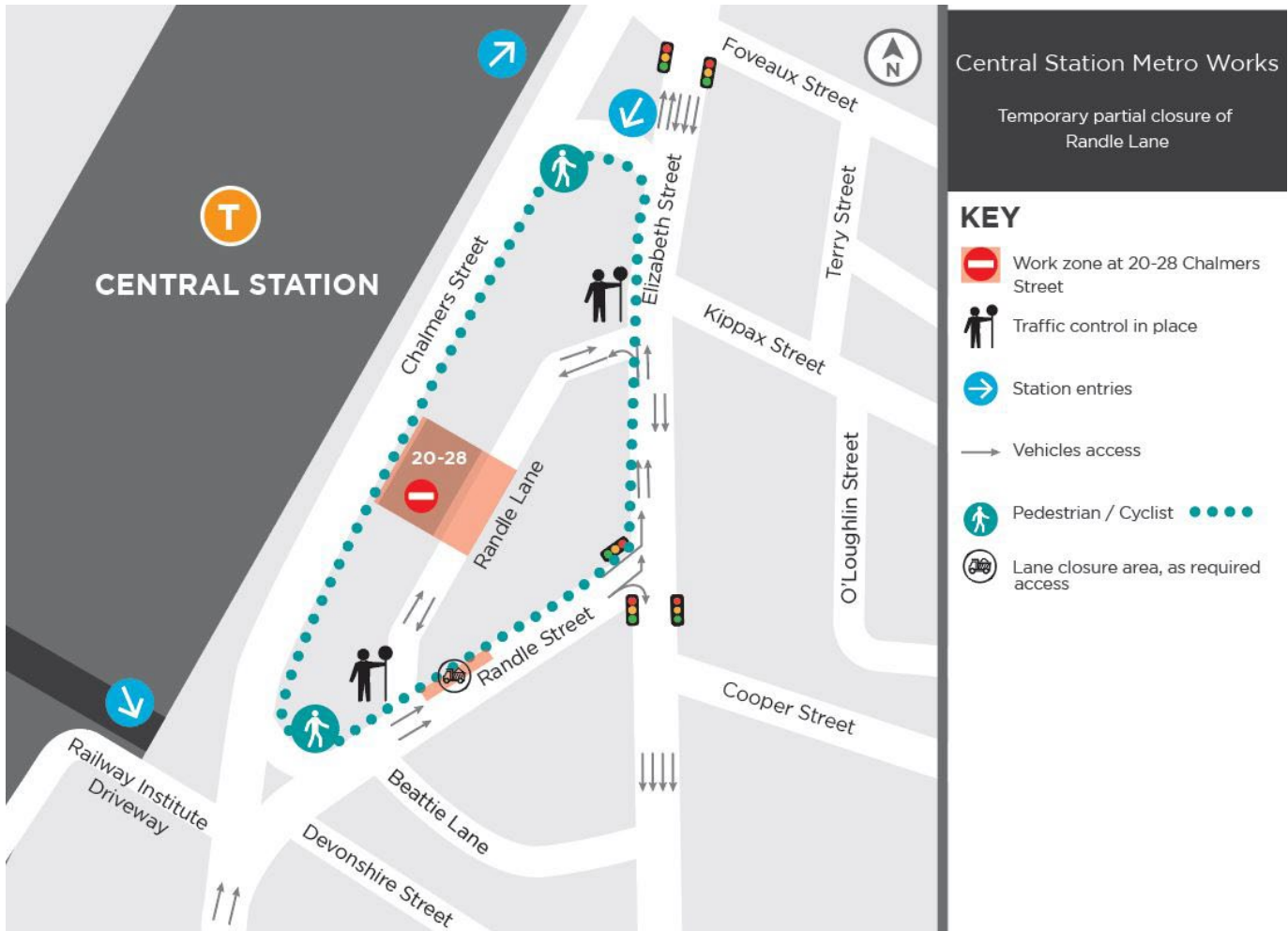

The map above depicts the location of the temporary partial closure of Randle Lane on **Thursday 19 to Saturday 21 January**. Should the above dates not be possible, the following contingency dates – two working days between **Monday 23 January and Friday 27 January**.

Thank you for your patience while we undertake these necessary works. Please register for email updates at sydnemetro.info for further information, or contact us on **1800 171 386** or via centralstationmetro@transport.nsw.gov.au.

SMCSWCSM-LOR-SMC-CL-COM-000154

- 1800 171 386** Community information line open 24 hours
- sydnemetro@transport.nsw.gov.au
- Sydney Metro City & Southwest, PO Box K659, Haymarket NSW 1240
- If you need an interpreter, contact TIS National on **131 450** and ask them to call **1800 171 386**