

# Notification – Central Station

25 October 2022

Sydney Metro is Australia's biggest public transport project.

Services started in May 2019 in the city's North West with a train every four minutes in the peak. Metro rail will be extended into the CBD and beyond to Bankstown, with new CBD metro railway stations at Martin Place, Pitt Street and Barangaroo and new metro platforms at Central. By 2030, Sydney will have a network of four metro lines, 46 stations, and 113km of new metro rail.

## Change of barriers and linemarking - Chalmers Street, Surry Hills

**From 6pm on Tuesday 1 November to 7am on Wednesday 2 November 2022**, the orange barriers along the shared path in front of the Chalmers Street construction site will be removed, linemarking will take place, and new bollards will be installed (See [map overleaf](#)). This work is required to be undertaken outside of standard construction hours when Light Rail is not operating.

### What to expect

- Traffic control will be in place to manage pedestrian, cycle, and vehicle movements
- Tools used will include pallet jacks, linemarking machinery, generator and handtools
- Increased construction vehicle movements should be expected in and around the work area
- If inclement weather, this work may be postponed to another night during the week.

### Access changes

- **Pedestrians will be temporarily detoured** to the western footpath on Chalmers Street while the works occur
- **Cyclists will be temporarily detoured** via Randle and Elizabeth streets while the works occur.

**Thank you for your cooperation while we complete this essential work.**

## Work area – Chalmers Street, Surry Hills

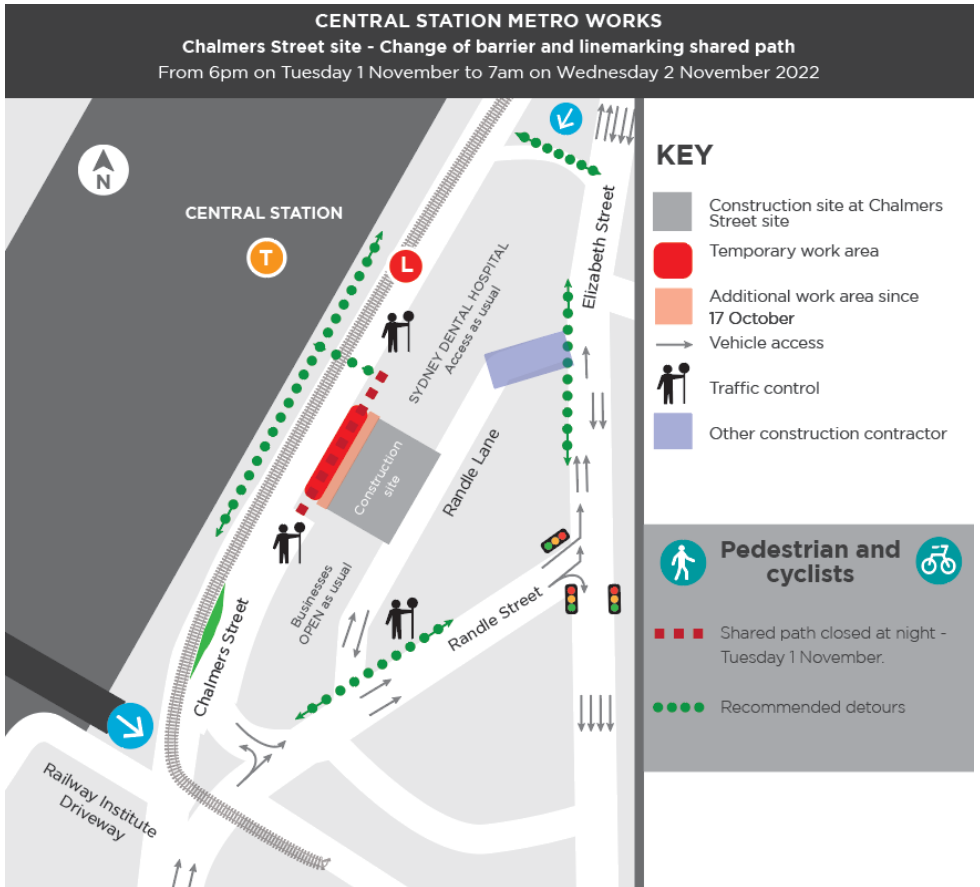

SMCSWCSM-LOR-SMC-CL-COM-000150

 **1800 171 386** Community information line open 24 hours

 **[sydneymetro@transport.nsw.gov.au](mailto:sydneymetro@transport.nsw.gov.au)**

 Sydney Metro City & Southwest, PO Box K659, Haymarket NSW 1240

 If you need an interpreter, contact TIS National on **131 450** and ask them to call **1800 171 386**

[sydneymetro.info](http://sydneymetro.info)