

Notification – Central Station

7 October 2022

Sydney Metro is Australia's biggest public transport project.

Services started in May 2019 in the city's North West with a train every four minutes in the peak. Metro rail will be extended into the CBD and beyond to Bankstown in 2024 with new CBD metro railway stations at Martin Place, Pitt Street and Barangaroo and new metro platforms at Central. By 2030, Sydney will have four metro lines, with 46 stations and 113 kilometres of new metro rail.

Laing O'Rourke is delivering the new Sydney Metro platforms under Central Station as well as the landmark Central Walk - a new underground pedestrian concourse to help customers get around Sydney's busiest railway station.

Work at 20-28 Chalmers Street: hoarding, footpath, and bike lane changes

Construction of the new Chalmers Street entrance to Central Station is continuing. In October, Sydney Metro will remove the existing hoarding in front of the work site and install new hoarding which will close the footpath. This is necessary to make enough space to continue working on the new entrance, its façade and services installation.

Starting **Friday 14 October (6pm)**, work to change the hoarding and bike lane will continue until **Monday 17 October (7am)**. The work will occur 24/7 over this weekend. A temporary work area will be established, and cyclists and pedestrians will be detoured via Randle and Elizabeth streets during this period, and to the footpath on the western side of Chalmers Street. Once the new hoarding is installed, the existing bike lane next to the footpath will be opened as a **shared path for bikes and pedestrians. This shared path arrangement will be in place over the next 12 months.**

What to expect

- Some activities will be noisy. Mitigation measures will be in place to minimise disruption, including attended noise monitoring and noise blankets
- Machinery used will include jackhammers, rattle guns, a crane, hiab trucks, power saws, asphalt rollers, scissor lifts, forklifts, extended work platforms, an asphalt paver, construction vehicles and trucks, along with hand tools and hand-operated power tools
- Traffic control will be in place to safely manage vehicles, pedestrians, and cyclists
- Construction vehicles will be moving around the work area to complete deliveries and work activities.

All businesses including the Sydney Dental Hospital will remain open as usual during this work. Access to businesses will be maintained at all times.

Access changes

- **Pedestrians will be temporarily detoured** to the western footpath on Chalmers Street **from 6pm Friday 14 October until 7am Monday 17 October**
- **Cyclists will be temporarily detoured** via Randle and Elizabeth streets **from 6pm Friday 14 October until 7am Monday 17 October**. These detours are required to facilitate work within the footpath and bike lane
- **On completion of the works**, the bike lane directly in front of the site will become a shared path for bikes and pedestrians.

Randle Lane

There will be increased vehicle movements in Randle Lane while this work occurs. Access to private vehicles into the lane will be maintained, however there may be short delays. Traffic control will be in place to safely manage the area during this period.

Work area on Chalmers Street

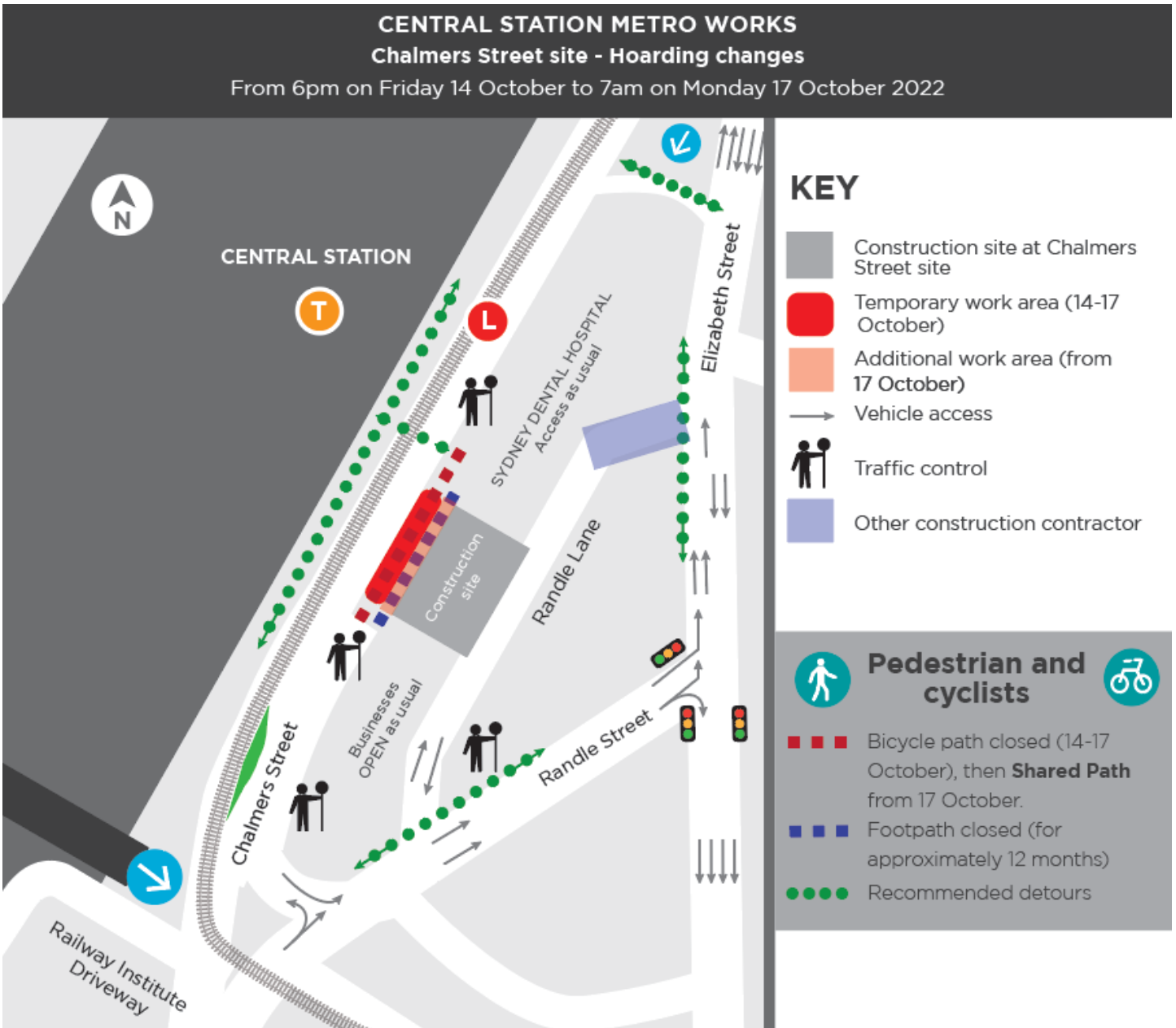

Thank you for your patience while we undertake these necessary works.

Please register for email updates at sydnymetro.info for further information, or contact us on **1800 171 386** or via centralstationmetro@transport.nsw.gov.au.

SMCSWSCSM-LOR-SMC-CL-COM-000149

- 1800 171 386** Community information line open 24 hours
- sydnymetro@transport.nsw.gov.au
- Sydney Metro City & Southwest, PO Box K659, Haymarket NSW 1240
- If you need an interpreter, contact TIS National on **131 450** and ask them to call **1800 171 386**