

# Notification – Central Station

6 December 2021

Sydney Metro is Australia's biggest public transport project.

Services started in May 2019 in the city's North West with a train every four minutes in the peak. Metro rail will be extended into the CBD and beyond to Bankstown in 2024. There will be new CBD metro railway stations at Martin Place, Pitt Street and Barangaroo and new metro platforms at Central.

## Oversize night-time deliveries

As part of Sydney Metro's work at Central Station, the reinstatement of Platforms 13-14 is now underway. In the coming months, new overhead canopies will be installed for the future platforms. These canopies have been manufactured off-site, reducing construction impacts at Central Station.

From **11:30pm to 5:30am** on **Monday 13 December to Sunday 19 December**, new platform canopies will be delivered on **oversize trucks**.

### What to expect

- Up to six deliveries will occur per night on the dates specified above
- The trucks will reverse over the Sydney Yard Access Bridge and on to Regent Street to leave the site.
- The reversing squawkers on the trucks will be disabled to reduce noise impacts for local residents. Spotters will guide the trucks safely out of the site
- There will be traffic control in place on Regent Street to allow the trucks to exit onto the street, and safely guide local traffic, pedestrians and other road users where required. There may be delays while traffic is stopped to allow the trucks to exit.
- Similar deliveries will occur in January 2022.

***Thank you for your cooperation while we complete this essential work.***

## Work area – Chippendale

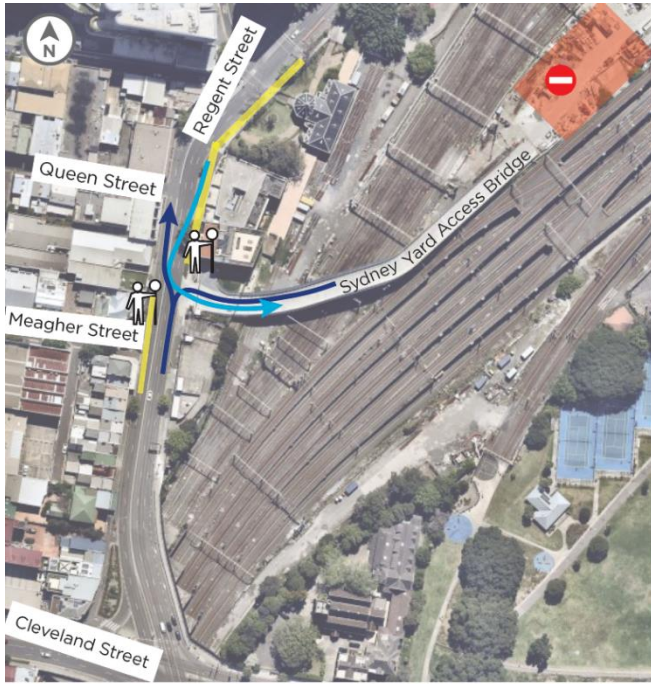

### Central Station Metro Works Oversize night time deliveries

Monday 13 December to  
Sunday 19 December 2021

#### KEY



Work zone



Traffic control

Regent Street in use  
during truck movements

Route for vehicle:



> entering the site



> exiting the site

#### TRAFFIC

Entry to CSM site is via  
the Sydney Yard Access  
Bridge, deliveries to site  
are permitted 24/7.

SMCSWCSM-LOR-SMC-CL-COM-000125



**1800 171 386** Community information line open 24 hours



**[sydneymetro@transport.nsw.gov.au](mailto:sydneymetro@transport.nsw.gov.au)**



Sydney Metro City & Southwest, PO Box K659, Haymarket NSW 1240



If you need an interpreter, contact TIS National on **131 450** and ask them to call **1800 171 386**