

NOTIFICATION – PITT STREET NORTH | 9 MAY 2019

Sydney Metro is Australia's biggest public transport project.

Services start in 2019 in the city's North West with a train every four minutes in the peak. Metro rail will be extended into the CBD and beyond to Bankstown in 2024. There will be new CBD metro railway stations at Martin Place, Pitt Street and Barangaroo and new metro platforms at Central.

In 2024, Sydney will have 31 metro railway stations and a 66 km standalone metro railway system. There will be ultimate capacity for a metro train every two minutes in each direction under the Sydney city centre.

John Holland CPB Ghella (JHCPBG) is building the 15.5 kilometre long twin railway tunnels between Chatswood and Sydenham and excavating six new metro stations, including one at Pitt Street.

Clearing a stormwater blockage at Pitt Street North site

Work to clear a blockage in a stormwater pipe in Pitt Street outside the Pitt Street North site (see map over page) has been scheduled for **Thursday 16 May 2019 between 8pm and 5am**, subject to weather and site conditions. This work is expected to take one night.

Out-of-hours work will involve:

- Temporarily closing a traffic lane in Pitt Street and diverting the pedestrian pathway around the work area.
- Establishing and removing work area safety controls.
- Using hand tools to open the stormwater cover and to close it on completion.
- Using high-pressure jets and a vacuum truck to remove the blockage.
- Using a diesel generator.

Work hours

Standard construction hours are Monday to Friday between 7am and 6pm and Saturday between 8am and 1pm. Due to high daytime traffic volumes and the need to ensure pedestrian safety, this work will be completed outside standard construction hours. Should the work be postponed for any reason it will be done on another week night between 8pm and 5am.

What to expect

- Temporary pedestrian and traffic changes including a traffic lane closure around the work area.
- Traffic control and directional signage will be in place for the safety of workers and the community.
- Non-tonal reversing beepers will be used, and equipment and vehicles will be turned off when not in use.
- At least one north-bound lane of Pitt Street will remain open at all times.
- Access to buildings and driveways will not be affected.

Thank you for your cooperation while we complete these essential works.

If you have any questions please contact **1800 171 386** (24 hour community line) or tunnels@transport.nsw.gov.au.

Work area next to Pitt Street North site

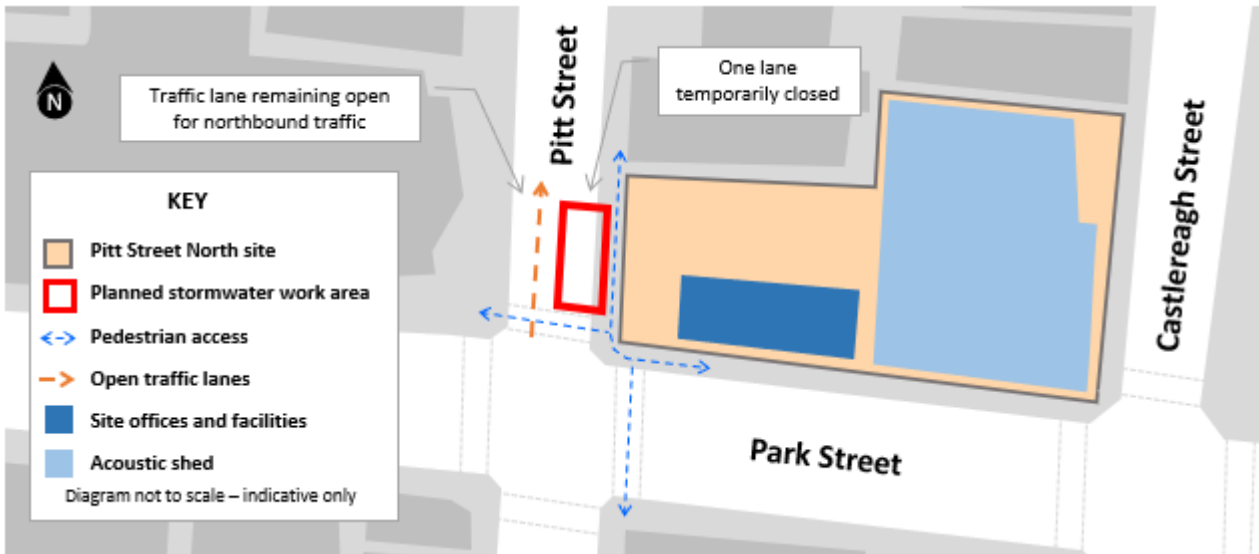

SMCSWTSE-JCG-SPS-SH-NFS-030565



If you require the services of an interpreter, please contact the **Translating and Interpreting Service on 131 450** and ask them to call **Sydney Metro on 1800 171 386**. The interpreter will then assist you with translation.

sydneymetro.info
1800 171 386
tunnels@transport.nsw.gov.au